



INDUSTRIAL UNITS 01-05 - GROUND FLOOR

LOT 100 DP 815116
 2 COWPASTURE PLACE, WETHERILL PARK NSW 2164

APRIL 2022 | MARKETING PURPOSES ONLY

20-022 SK902 A

UNIT NUMBER	GROUND FLOOR AREA (INCLUDING AMENITIES)	MEZZANINE FLOOR AREA	TOTAL AREA (APPROXIMATE)
UNIT 01	108.4m ²	38.6m ²	147.0m ²
UNIT 02	127.5m ²	45.2m ²	172.7m ²
UNIT 03	132.9m ²	22.4m ²	155.3m ²
UNIT 04	132.9m ²	22.4m ²	155.3m ²
UNIT 05	134.3m ²	45.2m ²	179.5m ²

(ALL AREAS TAKEN TO INTERNAL FACE OF WALLS)

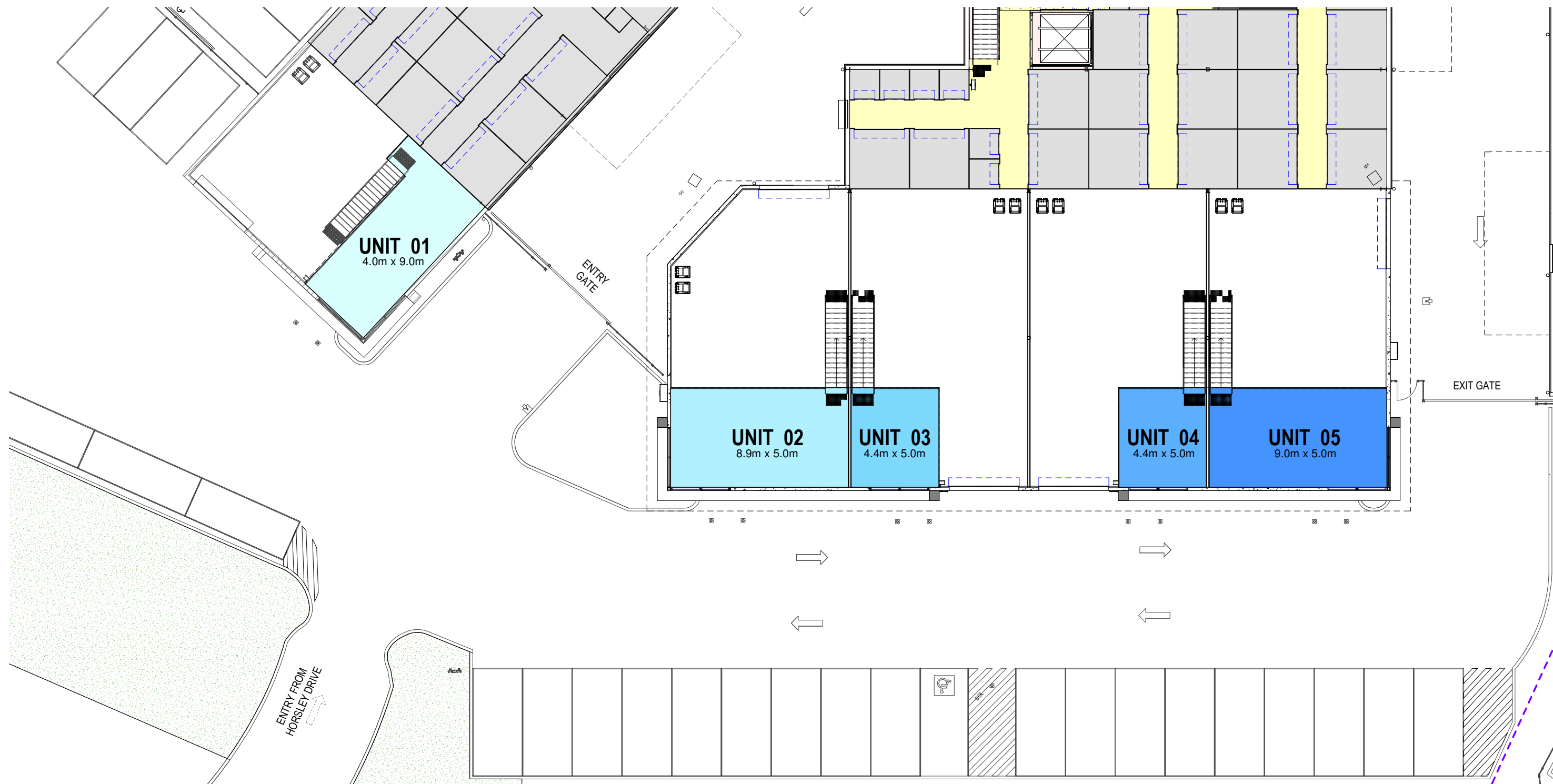

INDUSTRIAL UNITS 01-05 - MEZZANINE FLOOR

LOT 100 DP 815116
2 COWPASTURE PLACE, WETHERILL PARK NSW 2164

APRIL 2022 | MARKETING PURPOSES ONLY

20-022 SK903 A

UNIT NUMBER	GROUND FLOOR AREA (INCLUDING AMENITIES)	MEZZANINE FLOOR AREA	TOTAL AREA (APPROXIMATE)
UNIT 01	108.4m ²	38.6m ²	147.0m ²
UNIT 02	127.5m ²	45.2m ²	172.7m ²
UNIT 03	132.9m ²	22.4m ²	155.3m ²
UNIT 04	132.9m ²	22.4m ²	155.3m ²
UNIT 05	134.3m ²	45.2m ²	179.5m ²

(ALL AREAS TAKEN TO INTERNAL FACE OF WALLS)